

SUNSTUDIOS | BACKED
BY CANON

PRODUCER'S PACK

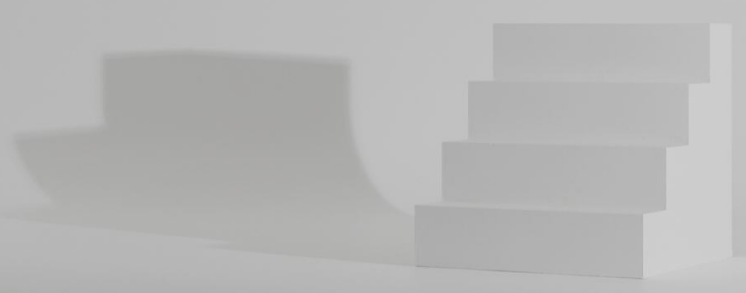

CONTACT

CONTACT DETAILS

Studios Rental / Catering / Set Build
melbourne@sunstudiosaustralia.com
03 8695 9700

STUDIO MANAGER

Drew Els
drew.els@sunstudiosaustralia.com
03 8695 9700

ADDRESS

95 Buckhurst Street, South Melbourne, VIC 3205

PARKING

SUNSTUDIOS Melbourne provides 2 standard car spaces per studio in our on-site car park.

Limited loading bay parking is available upon request. Limited street parking is available off site in the streets surrounding the building.

All day parking is available on one side of Buckhurst Street directly in front of the building.

RECEPTION & DELIVERIES

If you anticipate packages arriving before your shoot date, please give prior notice to the Studios team to ensure these items are stored safely for your shoot.

We kindly ask that any items being sent before your shoot are delivered between 8:30am – 5pm and clearly marked with the following information:

- Photographer
- Job Number / Reference
- Shoot Date(s)
- Studio Number
- Full Name & Contact Information
- All couriers must deliver to the Front Desk only.



LOCAL RESOURCES

POLICE

South Melbourne Police Station

211 Bank Street, South Melbourne VIC 3205
Telephone. +61 3 9257 3800

HOSPITAL

The Royal Melbourne Hospital

300 Grattan Street (corner of Royal Parade)
Parkville, Victoria 3050 Australia
Telephone. +61 3 9342 7000

TAXI

Silver Service

Telephone: 03 9088 0445
Mobile: 0450 665 464

SUPERMARKETS

Woolworths

113 Cecil Street, South Melbourne, VIC, 3205
(10 min walk, 5 min drive)

Dan Murphys

100 Market Street, South Melbourne, VIC, 3205

Coles Local

253-273 Normanby Rd, South Melbourne VIC 3205
(8 min walk, 4 min drive)

TRANSPORT

Montague St Light Rail Station

Corner Montague st and Gladstone Lane, South Melbourne
(4 min walk)
Lines serviced: 109 Tram

AIRPORT

Melbourne Airport (Tullamarine)

SITE MAP

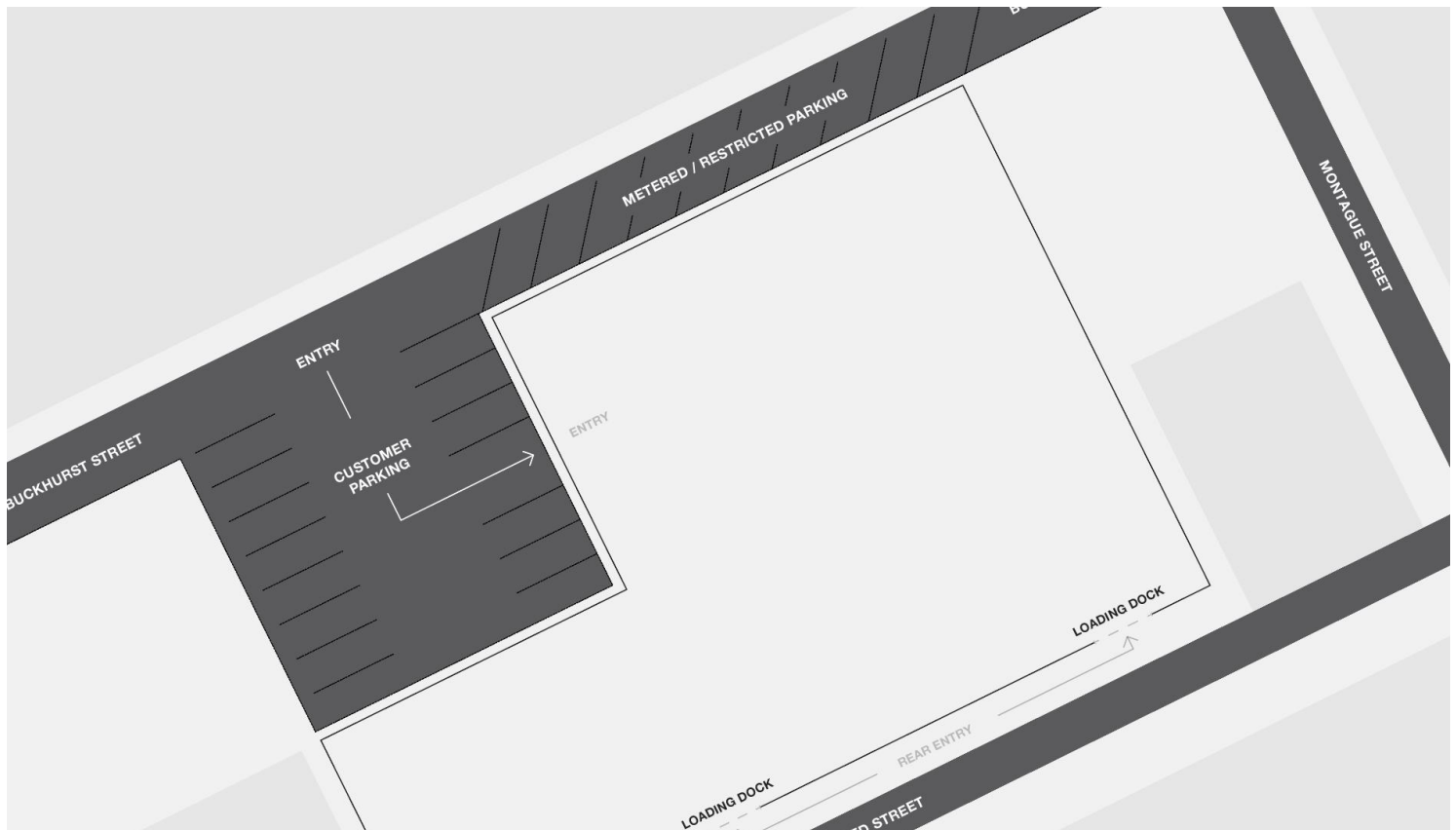
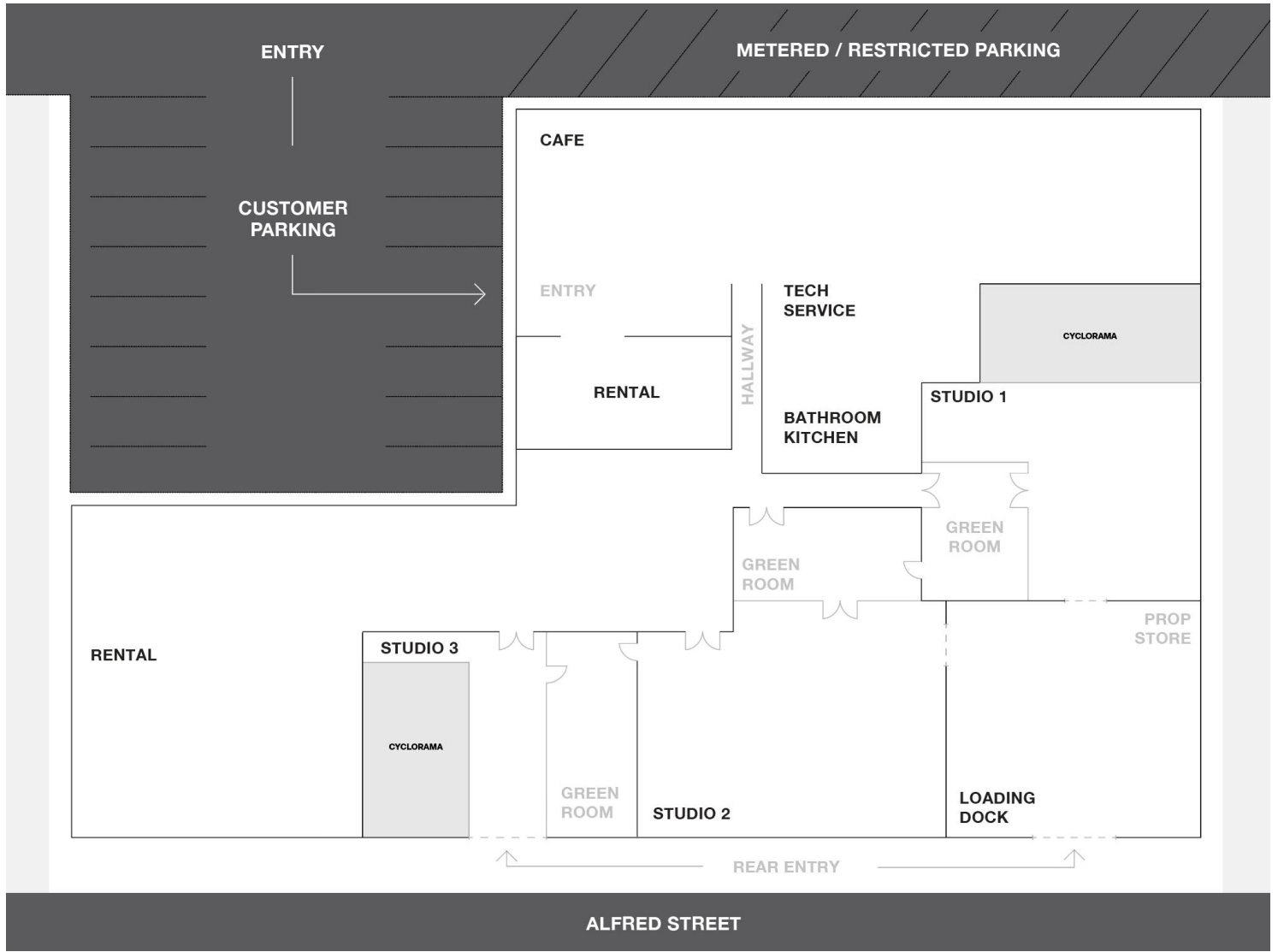

CONTACT DETAILS

At SUNSTUDIOS we care about the safety of your crew and our staff, guests and customers. Please notify the Studios front desk if you need to use any of the following:

- Studio flats, walls, or surfaces
- Burning materials, sparks or open flame
- Glitter/pigment
- Liquids - including water, paint, oil
- Hazardous chemicals
- Ladder/Rigging
- Gas bottles

ALSO, PLEASE NOTE THE FOLLOWING:

CYCLORAMA

Pressure or weight cannot be placed on the curve of the cyclorama. This is a dry area that cannot come in contact with any liquids.

PAINTING

If you require a painted flat, plinth or cyc touch up, please see the front desk to be provided with the necessary tools and drop sheets.

YOUR PROPERTY

Please keep an eye on your property at all times.

TERMS & CONDITIONS

Please see our website for a full list of Terms and Conditions.

We pride ourselves on being a premium facility and appreciate your assistance in maintaining this standard.

If you cause damage or leave the studio in an excessively dirty condition, costs may be forwarded on.



READY TO BOOK?
SHOOT US AN EMAIL NOW!

[EMAIL US →](#)

